

# Adventure

2020 SERIES





# Adventure awaits...



Welcome to Jayco's 2020 range; in our 45th year innovation still remains at the forefront of the seven product ranges Jayco offers you, with each range ready to take you off on your next adventure.

Jayco's 2020 range illustrates how we have honed our innovation expertise to focus on three core developments – to improve connectivity, safety and security all achieved by uncompromising comfort and style that Jayco products are known for.

Connectivity comes in the form of your very own personal assistant – Amazon Alexa – now available in a number of Jayco caravans which proved popular when Jayco created a world-first voice-activated production RV with Jayco's Silverline 2019 caravan.

In 2020, Jayco's Adventure range is ready to meet your desire for further exploration. Built to last right here in Australia for Australian conditions with all the comfort of Jayco's next generation of caravans.

Adventure awaits in your Jayco caravan.





## Kick-start your adventure!

Jayco understands that adventure can come in many shapes and forms and that's why we have a variety of action-packed models ready for the taking.

Built on the new generation of Jayco chassis with JTECH 2.0 suspension. JTECH 2.0 is designed specifically for off-road adventures, that means you can venture further with confidence thanks to proven protection against corrosion.

Market-leading Jayco Toughframe quad-layer wall construction is further strengthened by the checkerplate body armour.





# J-Pod.



J-Pod Sport

J-Pod Outback

## Designed with simple adventure in mind.

J-Pod is Jayco's answer to the newest trend of lightweight trailers that can be towed behind your average sedan or small SUVs, which opens up a world of RV travel to a new generation.

The two models in the J-pod range, Sport and Outback, have been designed with adventure in mind. Both are fully equipped to carry a kayak or bike on the roof, which means hitting the road and fulfilling the desire for travel and adventure is made easy.

Each J-Pod sleeps two in a double bed, comes complete with a slide out kitchen that includes a burner and fridge, as well as an attachable tent to use as an outdoor room.

J-Pod punches above its weight when it comes to the opportunity for the adventures it opens up, but with a tare weight starting from only 790 kg it is easy to tow and store.

If freedom and spontaneity is how you like to travel - J-Pod is the RV made for your next adventure.



Savvy use of space is a highlight of the J-Pod, which includes innerspring double mattress and bed reading lights, Sphere 45L fridge, and plenty of storage options.



Featuring a large external tent for additional sleeping options and storage and even a pull-out awning to enhance your outdoor experience.

## Everything you need to start exploring.

The Jayco J-pod's unique design marries functional living with practical space saving. Its savvy design comes with even more features in 2020. The interior has been fitted out with bigger and better components with a larger 45L portable fridge, there's even bed reading lights, ideal for relaxing at the end of the day. External features keep the adventures rolling on with a rear overnight tent, external slide out kitchen with cooktop<sup>^</sup>, an awning and a large front toolbox.

There are several extras available to customise the J-pod to suit your lifestyle new for 2020 models such as a convenient pull down strap for the rear door and optional picnic table for enjoying meals outside without bringing along a portable table.



JTECH 2.0 Independent Coil suspension delivers greater, durability, stability, a smoother ride to handle road undulations with ease.\*



J-Pod is compact in design, but big on innovation. There is no shortage of clever storage options like a large chassis mounted toolbox and external storage to safely stow your belongings.



Make the most of the outdoors with a convenient 2.1m side awning available on both Sport and Outback Models.

# J-Pod Features.

• Standard   ✕ Optional   - Not Available   ^ Model Specific



	SPORT	OUTBACK
<b>CONSTRUCTION</b>		
Chassis - Hot dipped galvanised	•	•
Furniture - Euro style with aluminium corners & seat framing	•	•
Roof - sandwich construction, one piece fibreglass skin	•	•
Suspension - axle & leaf springs	•	-
Suspension - JTECH Suspension Independent Coil	-	•
Walls - fully insulated Toughframe, hail & dent resistant	•	•
<b>SAFETY</b>		
Electric Brakes	•	•
Lockable Water Filler	•	•
<b>STORAGE</b>		
Large Storage area under bed	•	•
Purpose designed internal storage tubs	•	•
<b>TECHNOLOGY</b>		
100 Ah Battery	•	•
Bluetooth enabled for battery and water tank monitoring app	•	•
Bluetooth speaker dock to suit Furrion Portable speaker	•	•
Built in battery management system with built in 240v charger	•	•
Roof mounted 150w Solar Panel	-	•

	SPORT	OUTBACK
<b>INTERIOR FEATURES</b>		
45L Portable Fridge/Freezer	•	•
Double bed	•	•
Innerspring Mattress to main bed	•	•
<b>EXTERIOR FEATURES</b>		
240v Power outlet doorside	•	•
12v Power outlet doorside	•	•
Alloys & Tyres - 185/R14 HT including spare	•	-
Alloys & Tyres - 235/75R15 AT including spare	-	•
Bag awning	•	•
Corner steadies - Drop	-	•
Corner steadies - Wind down	•	-
Coupling - Swivel	-	•
Fresh Water tank - Sport: 45L   Outback: 80L	•	•
Front Tool Box	•	•
Gas Bottles - 1 x 4kg	•	-
Gas Bottles - 1 x 9kg	-	•
Gas Bottles - 2 x 9kg	-	✕

	SPORT	OUTBACK
<b>EXTERIOR FEATURES (CONTINUED)</b>		
Jerry Can holder	-	•
Jockey Wheel - Side mount	•	•
Light - LED 12v side	•	•
Mudflaps	-	•
Nitrogen filled tyres	•	•
Pebbleguard stone protection at front	•	•
Picnic table	✕	✕
Rear tent section for added privacy	•	•
Roof Rack	•	•
Side checkerplate protection	-	•
Slide out external kitchen with cook top and sink	-	•
Slide out external kitchen with sink	•	-
Under mounted gas bayonet for external cooking	•	•





# J-Pod Floorplan.

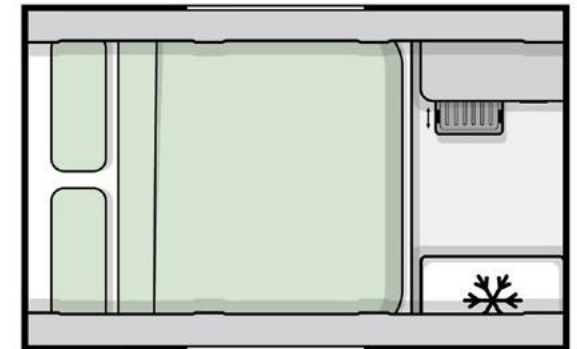

COOKTOP STANDARD  
ON OUTBACK MODEL  
(OPTIONAL ON  
SPORT MODEL)

\* Refrigerator    ● Sleeps standard



J-Pod Single Axle	SPORT	OUTBACK
Tare Weight (approx)	790 kg	966 kg
Towball Weight (approx)	85 kg	122 kg
Body Length	2850 mm	2850 mm
Interior Height	1295 mm	1295 mm
Travel Height	2085 mm	2300 mm
Travel Length	4075 mm	4405 mm
Travel Width	1860 mm	1860 mm

The weights and dimensional data are not binding. Jayco reserve the right to alter specifications without notice. These are a guide only and will change depending on accessories fitted to your van. It is advised to discuss this with your Jayco representative. The load carrying capacity of Jayco RV's vary from product to product to ensure it is fit-for-purpose.



# JTrak Tent Trailer.



JTrak TRX

JTrak OBX

## Get your adventure on track.

JTRAK is Jayco's much anticipated tent trailer offering, and is ideal for campers looking to transition to a caravan or perfect for those fishing buffs looking for ways to explore the hidden fishing meccas.

The quick and easy set-up of the JTRAK is its key feature, along with an inflatable annex option, which is exclusive to Jayco. JTRAK was also the first Jayco product to showcase the new generation of Jayco chassis with JTECH 2.0 suspension<sup>^</sup>.

Get your next adventure on track, in your JTRAK.







JTRAK tent section comes with window awnings for sun and light rain protection.



Immerse in your adventure with a fully openable partition on the lounge section.

## Everything you need to start exploring.

Both JTRAK models sleep up to 4 people: there is a double bed, ideal for 2 adults and a dinette area converts into the second bed which is great for the kids. Australian made, Australian sourced, the 10 oz JTRAK tent section comes with window awnings for sun and light rain protection. Immerse in your adventure with a fully openable partition on the lounge section.

Fully featured slide-out kitchen contains a three-burner cooktop with flame failure device, stainless steel sink, ample storage space, removable shelf and LED light. There are two bayonets underneath for gas, to keep you cooking. With the external 12v socket you can charge your devices while you BBQ.



Australian engineered and manufactured JTECH 2.0 trailing-arm suspension is compact in size, durable and reacts better to road undulations.\*



Fully featured slide-out kitchen contains a three-burner cooktop with flame failure device, stainless steel sink with 12v water pump, ample storage space, removable shelf and LED light.



Smart storage solutions like the large storage boxes with heavy duty seals and slide out trays allow you to take more on your adventure.



# JTrak Features.

• Standard    ✕ Optional    - Not Available



*JTrak TRX packs down for easy towing and storage.*

*JTrak OBX with boat rack: Pack the boat with ease with the handy boat rack and go further on the Dual 16-inch wheels.*

	TRX	OBX
<b>CONSTRUCTION</b>		
Chassis - Streamline hot dipped galvanised	•	•
Furniture - Euro style with aluminium corners & seat framing	•	•
Suspension - axle & leaf springs	•	-
Suspension - JTECH Suspension Independent Coil	-	•
Walls - Hot dipped galvanised construction	•	•
Walls - Smooth skin gunmetal grey clad	•	•
<b>SAFETY</b>		
Electric Brakes	•	•
Lockable Water Filler	•	•
<b>STORAGE</b>		
Side Entry Boot	•	•
Slide out heavy duty storage drawer	•	•
<b>TECHNOLOGY</b>		
100 Ah Battery	•	•
Additional 100 Ah Battery	-	•
Built in battery management system with built in 240v charger	•	•
<b>INTERIOR FEATURES</b>		
12V & USB charging points	•	•
High density foam mattress	•	•
LED strip lighting	•	•
Seating area with selection of modern fabrics	•	•

	TRX	OBX
<b>EXTERIOR FEATURES</b>		
Alloys & Tyres - 185/R14 HT including spare	•	-
Alloys & Tyres - 235/75R15 AT including spares (x2)	-	•
Corner steadies - Drop	-	•
Corner steadies - Wind down	•	-
Coupling - 50mm Ball	•	-
Coupling - Swivel	-	•
Fresh Water tank - 1 x 65L	•	-
Fresh Water tank - 2 x 65L	-	•
Front and rear winch	•	•
Front Tool Box	-	•
Gas Bottles - 1 x 9kg	•	-
Gas Bottles - 2 x 9kg	-	•
Inflatable Annexe	✕	✕
Jerry Can holder	•	•
Jockey Wheel - Side mount	•	•
Light - LED 12v doorside	•	•
Mudflaps	•	•
Nitrogen filled tyres	•	•
Roof Rack	-	•
Slide out external kitchen with cook top and sink	•	•
Tent section - One Piece, Double Stitched, heavy duty canvas	•	•
Under mounted gas bayonet for external cooking	•	•







# JTrak Layout.

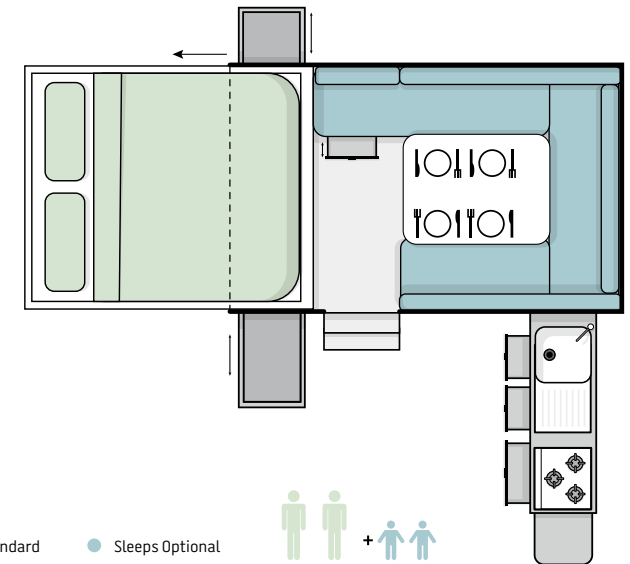

JTrak Single Axle Tent Trailer	TRX	OBX
Tare Weight (approx)	1015 kg	1400 kg
Towball Weight (approx)	130 kg	170 kg
Body Length	2800 mm	2800 mm
Interior Height	2300 mm	2300 mm
Travel Height	1450 mm	1500 mm
Travel Length	4800 mm	5100 mm
Travel Width	1900 mm	2015 mm
Rear Bed Width	1400mm	1400mm
Open Length	4200mm	4200mm

The weights and dimensional data are not binding. Jayco reserve the right to alter specifications without notice. These are a guide only and will change depending on accessories fitted to your van. It is advised to discuss this with your Jayco representative. The load carrying capacity of Jayco RV's vary from product to product to ensure it is fit-for-purpose.



# CrossTrak Hybrid.



13 ft CrossTrak

16 ft CrossTrak

## Adventure is calling.

CrossTrak keeps the adventures rolling into 2020.

Jayco's first ever purpose-built off-road hybrid product – CrossTrak – was launched in 2019 to rave reviews. And now, it's bigger and better in 2020 with even more features to set your adventures soaring.

The hybrid camper category is popular due to its compact and lightweight benefits and we wanted to ensure Jayco was responsible for producing the best off-road hybrid RV product in Australia.

The Jayco CrossTrak is compact and lightweight and the reduction in weight comes down to our market-leading hot-dipped galvanised Endurance 2.0 chassis (as seen on Silverline) and the JTECH 2.0 Independent trailing arm suspension.

Adventure is calling when you're in your Jayco CrossTrak.





Style and comfort haven't been compromised in the CrossTrak – comfort features include innerspring mattress and LED strip lighting.



Outdoor living is at its finest when you're adventuring in your CrossTrak with all you need to entertain outdoors with the external kitchen featuring 2 burner gas cooktop, stainless steel sink and an abundance of storage.

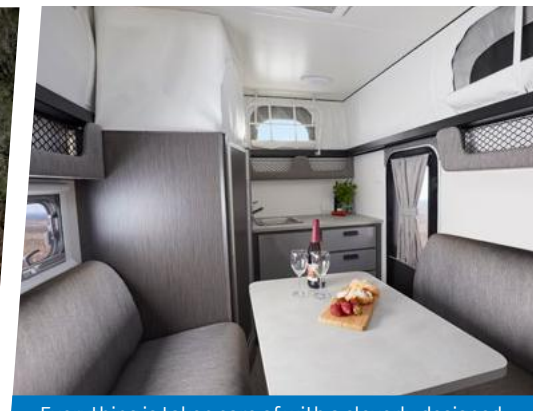

Everything is taken care of with a cleverly designed modern ensuite featuring all the creature comfort you would expect from home, like instantaneous hot water.

## Purpose built off-road hybrid.

The beauty of Jayco CrossTrak is that it's the next step up from a tent trailer with a pop-top solid roof so it's a great transition RV for those people looking to upgrade their RV.

It is built with off-roading travel at the forefront and comes with the security of Jayco's high quality in RV manufacturing reputation and includes phone app connectivity, which is now standard across the majority of Jayco's products.



Market-leading hot-dipped galvanised endurance 2.0 chassis and JTECH 2.0 Independent trailing arm specifically built to navigate those narrow tracks.



A standard 150W solar panel for charging your 100AMP deep cycle battery.



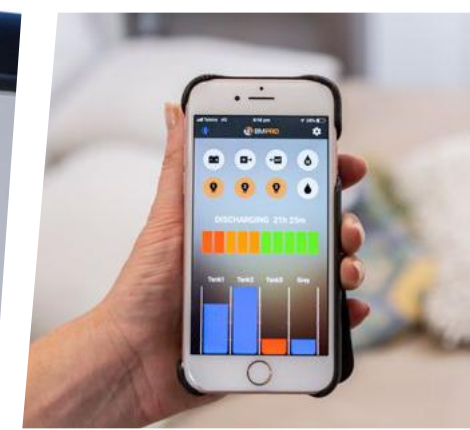

Tow and park with confidence with the inclusion of new safety feature - 360 cameras.



Keep track of your battery, solar and water levels with the new look phone app battery management system.

# CrossTrak Layouts.

 Shower
  Refrigerator
  Sleeps standard
  Sleeps Optional



CrossTrak 16.48-1 with large external kitchen

## 13 ft Double

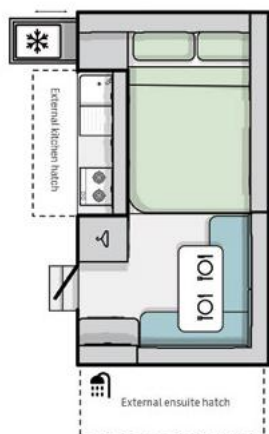

## 13 ft Bunk

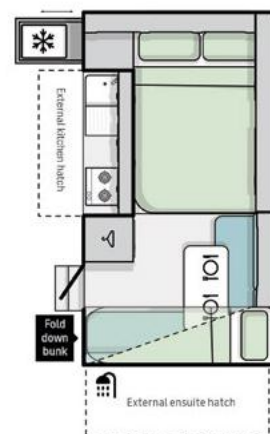

## 16 ft Ensuite

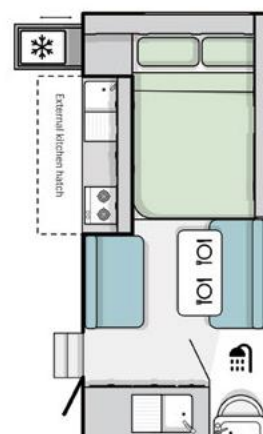

## 16 ft Bunk

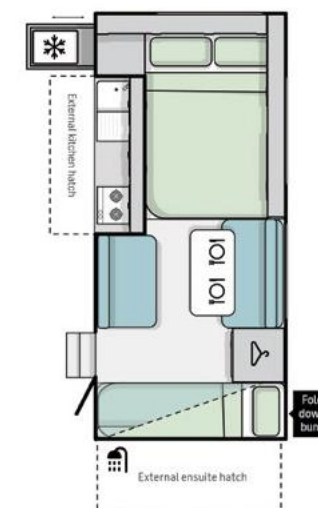

### 13.39-1 Single Axle Hybrid

Tare Weight (approx)	1354 kg
Towball Weight (approx)	131 kg
Body Length	4190 mm
Interior Height	2015 mm
Travel Height	2400 mm
Travel Length	5400 mm
Travel Width	2040 mm

### 13.39-2 Single Axle Hybrid

Tare Weight (approx)	1349 kg
Towball Weight (approx)	132 kg
Body Length	4190 mm
Interior Height	2015 mm
Travel Height	2400 mm
Travel Length	5400 mm
Travel Width	2040 mm

### 16.48-1 Single Axle Hybrid

Tare Weight (approx)	1534 kg
Towball Weight (approx)	159 kg
Body Length	4970 mm
Interior Height	2015 mm
Travel Height	2400 mm
Travel Length	6140 mm
Travel Width	2040 mm

### 16.48-2 Single Axle Hybrid

Tare Weight (approx)	1487 kg
Towball Weight (approx)	150 kg
Body Length	4970 mm
Interior Height	2015 mm
Travel Height	2400 mm
Travel Length	6140 mm
Travel Width	2040 mm

The weights and dimensional data are not binding. Jayco reserve the right to alter specifications without notice. These are a guide only and will change depending on accessories fitted to your van. It is advised to discuss this with your Jayco representative. The load carrying capacity of Jayco RV's vary from product to product to ensure it is fit-for-purpose.



# CrossTrak Features.

• Standard    ✕ Optional    - Not Available    ^ Model Specific



*Cleverly designed ensuite hatch.*

## CONSTRUCTION

Chassis - Streamline hot dipped galvanised	•
Furniture - Euro style with aluminium corners & seat framing	•
Roof - hail resistant one piece skin with insulation	•
Suspension - JTECH Suspension Independent Coil	•
Walls - fully insulated Toughframe, hail & dent resistant	•

## SAFETY

360 degree Cameras	•
Child restraints to bunk area^	•
External Triple Lock security door	•
Electric Brakes	•
Lockable Water Filler	•
Sway Command Tow Control	✕

## STORAGE

Large Storage area under bed	•
Overhead storage compartment	•
Side Entry Boot	•

## TECHNOLOGY

100 Ah Battery	•
100 Ah Lithium Battery	✕
Additional 100 Ah Battery	✕
Rear mounted 150w Solar Panel with regulator (roof mounted on 16.48-1)	•
Bluetooth enabled for battery and water tank monitoring app	•

## TECHNOLOGY (continued)

Bluetooth speaker dock to suit Furrion Portable speaker	•
Built in battery management system with built in 240v charger	•
24" LED 12v TV with built in DVD player	✕
CD/Radio with Internal & External Speakers	✕
LED display for battery and water tank monitoring	✕
Roof mounted TV antenna	✕

## INTERIOR FEATURES

2 Burner Cook top	•
55L Slide out Fridge/Freezer	•
Bed linen including doona and pillows	•
Double bed with orthopaedic slats	•
Gas Hot Water System	•
Innerspring Mattress to main bed	•
Rangehood with 12v LED light & twin fans^	•
Roof mounted Air Conditioner	✕
Seating area with selection of modern fabrics	•
Seating area with selection of durable leatherette	✕
Seating area with selection of genuine leather	✕
Shower with exhaust fan (16.48-1 only)	•
Water filtration system to sink	✕

## EXTERIOR FEATURES

12v Power outlet doorside	•
240v Power outlet doorside	•
Alloys & Tyres - 245/70R16 AT including spare	•
Corner steadies - Drop	•
Coupling - D0-35	✕
Coupling - Swivel	•
Extended A-Frame	•
Fresh Water tank - 2 x 80L	•
Gas Bottles - 2 x 9kg	•
Jerry Can holder	•
Jockey Wheel - Side mount	•
Light - LED 12v doorside	•
Light - LED 12v grab handle	•
Mains pressure to A-Frame tap	✕
Mudflaps	•
Nitrogen filled tyres	•
Rear mounted lift up shower hatch with privacy tent (N/A 16.48-1)	•
Roll out awning with LED Strip light	•
Slide out Step	•
Under mounted gas bayonet for external cooking	•
Window shield - front with gas assisted struts	•

# All-Terrain Range.



All-Terrain 13.43-2 Pop Top

All-Terrain 19.61-3 Bunk Caravan

## Built for adventure – the Jayco way.

The Jayco All-Terrain series is our toughest off-roader, purpose-built to tackle the tough Australian terrain.

Strength doesn't have to come at the expense of comfort: Jayco All-Terrain is a premium RV complete with all the trimmings but has extra rugged features to make packing up and heading off the grid that much easier.

With new features that set it apart from others like aluminium furniture construction and checker plate armour, the All-Terrain is ready for your adventure.

If you're after an adventure seeking, purpose built off-road RV – the Jayco All-Terrain range is all brawn.

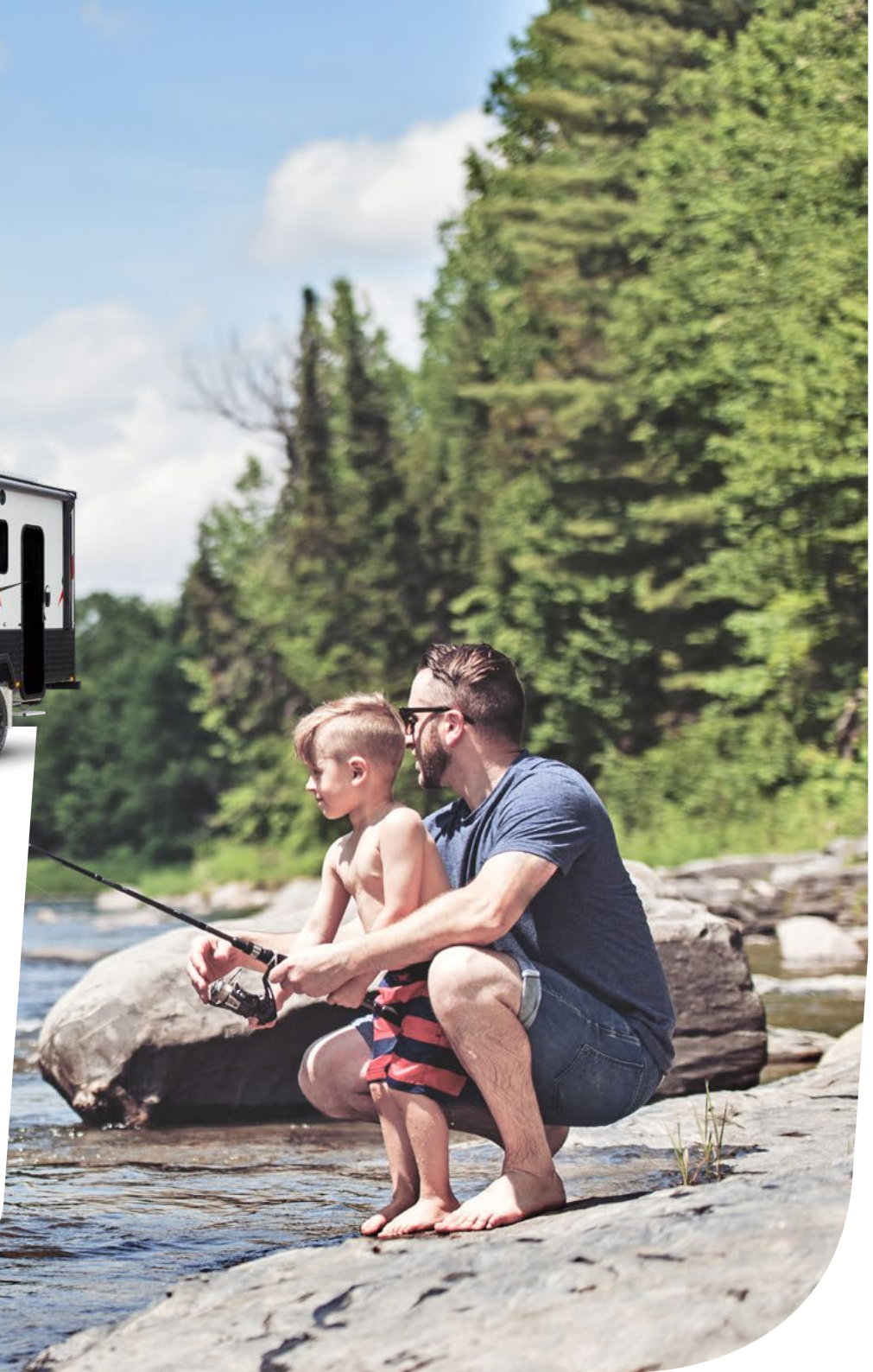





Simple touches escalate comfort in the All-Terrain Pop Top and Caravan with the spacious interior and inclusions such as the entertainment system.



Modern and stylish kitchen is discernible in both RVs and features either a 3 or 4-burner cooktop and plenty of bench space to prepare your meals.



Comfort uncompromised with the internal ensuite that brings a touch of home wherever your adventure takes you.

## Rugged features, uncompromised style.

Off-road adventures are made easy in your Jayco All-Terrain and in 2020, there's even more action-packed features to take your dream off-road holiday to the next level.

Packed with hardy off-road features that come standard in the All-Terrain, comfort and style is uncompromised throughout the interior with all the inclusions you'd expect to see in a luxury RV. No matter what the weather brings, your environment will be comfortable. High-flow Sirocco fans above the bed are ideal for long hot nights. On a fresh morning, you won't even need to get up from the bed to add warmth, thanks to the cleverly positioned control for the optional gas ducted heating.

**NEW:** New features in 2020 include Ibis 4 air-conditioning, perfect for keeping cool at the end of your daily adventures and matte black handles for a sleeker look.



JTECH 2.0 suspension has been designed specifically to keep your Jayco strong and safe under harsh Australian conditions, delivering greater stability, a smoother ride and more precise handling.



Take all your extra tools and accessories thanks to the large toolbox and side storage hatch located at the front of the All-Terrain.



Keeping cool on hot days is easy with the ultra-quiet and stylish Sirocco Fan.



Extra protection above and beyond the hail and dent resistant exterior with checker plate and stone deflector for superior armour when travelling off-grid.

# All-Terrain Floorplans.

 Shower
  Refrigerator
  Wardrobe
  Pantry
  Sleeps standard
  Sleeps Optional

## 13 ft Pop Top

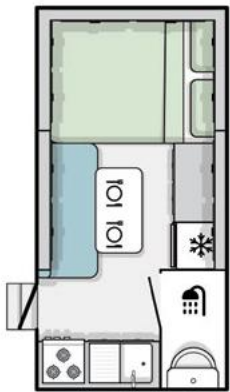

**13.43-2** Single Axle Pop Top

**ALL-TERRAIN**

Tare Weight (approx)	1800 kg
Towball Weight (approx)	181 kg
Body Length	4272 mm
Interior Height	2015 mm
Travel Height	2585
Travel Length	6481 mm
Travel Width	2326 mm

## 15 ft Caravan

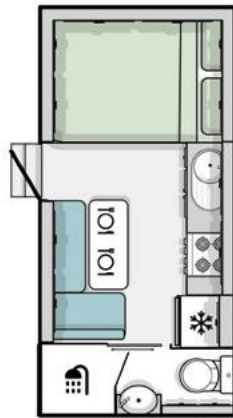

**15.47-1** Single Axle Caravan

**ALL-TERRAIN**

Tare Weight (approx)	1900 kg
Towball Weight (approx)	165 kg
Body Length	4775 mm
Interior Height	1975 mm
Travel Height	3100 mm
Travel Length	7067 mm
Travel Width	2470 mm

## 19 ft Caravan

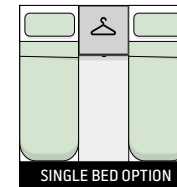
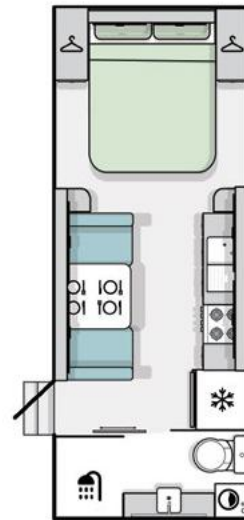

**19.61-2** Tandem Axle Caravan

**ALL-TERRAIN**

Tare Weight (approx)	2482 kg
Towball Weight (approx)	223 kg
Body Length	6045 mm
Interior Height	1975 mm
Travel Height	3055 mm
Travel Length	8230 mm
Travel Width	2470 mm

## 19 ft Bunk Caravan



**19.61-3** Tandem Axle Caravan

**ALL-TERRAIN**

Tare Weight (approx)	2450 kg
Towball Weight (approx)	220 kg
Body Length	6045 mm
Interior Height	1975 mm
Travel Height	3055 mm
Travel Length	8230 mm
Travel Width	2470 mm



# All-Terrain Features.

• Standard    ✕ Optional    ^ Model Specific



**Ready for anything:** Features like higher ground clearance, checkerplate, JTECH2.0 suspension, 16" alloy rims and All Terrain tyres make the All-Terrain our toughest RV

	POP TOP	CARAVAN
<b>CONSTRUCTION</b>		
Chassis - Hot dipped galvanised	•	•
Furniture - Euro style with aluminium corners & seat framing	•	•
Roof - hail resistant one piece skin with insulation	•	•
Suspension - JTECH Suspension Independent Coil	•	•
Walls - fully insulated Toughframe, hail & dent resistant	•	•
<b>SAFETY</b>		
360 degree Cameras	✕	✕
Brake Unit - Tow Secure Emergency Braking	•	•
Electric Brakes	•	•
External Triple Lock security door	•	•
Lockable Water Filler	•	•
Reversing Camera	✕	✕
Side Camera	✕	✕
Sway Command Tow Control	•	•
<b>STORAGE</b>		
Large Storage area under bed	•	•
Overhead storage compartment	•	•
Side Entry Boot	•	•
<b>TECHNOLOGY</b>		
100 Ah Battery (Caravan 2 x 100 Ah)	•	•
100 Ah Lithium Battery	✕	✕
2 x Roof mounted 160w Solar Panels	•	•
24" LED 12v TV with built in DVD player	•	•
Bluetooth enabled for battery and water tank monitoring app	•	•

	POP TOP	CARAVAN
<b>TECHNOLOGY (continued)</b>		
Built in battery management system with built in 240v charger	•	•
CD/Radio with Internal & External Speakers	•	•
Internal mounted WiFi system with built in GPS	•	•
LED display for battery and water tank monitoring	•	•
Roof mounted TV antenna	•	•
Winegard Sensor Pro Signal Amplifier	✕	✕
<b>INTERIOR FEATURES</b>		
3 Burner Cook top (4 Burner griller/oven in Caravan)	•	•
Bed linen including doona and pillows	•	•
Double bed with orthopaedic slats	•	•
Gas Hot Water System	•	•
Innerspring Mattress to main bed	•	•
Microwave	•	•
Modern design shower with exhaust fan	•	•
Rangehood with 12v LED light & twin fans	•	•
Roof mounted Air Conditioner	•	•
Seating area with selection of durable leatherette	•	•
Seating area with selection of genuine leather	✕	✕
Seating area with selection of modern fabrics	✕	✕
Truma Ducted Gas heating	✕	✕
Water filtration system to sink	✕	✕
<b>EXTERIOR FEATURES</b>		
12v Power outlet doorside	•	•
240v Power outlet doorside	•	•

	POP TOP	CARAVAN
<b>EXTERIOR FEATURES (continued)</b>		
Alloys & Tyres - 245/70R16 AT including spare	•	•
Awning walls	✕	✕
Corner steadies - Drop	•	•
Coupling - D0-35	•	•
Dust Reduction System (DRS)	•	•
External shower hatch	•	•
Fresh Water tank - 2 x 80L	•	•
Front Tool Box	•	•
Gas Bottles - 2 x 9kg	•	•
Grey Water tank^	✕	✕
Jerry Can holder x 2	•	•
Jockey Wheel - Side mount	•	•
Light - LED 12v doorside	•	•
Light - LED 12v grab handle	•	•
Mains pressure to A-Frame tap	•	•
Mudflaps	•	•
Nitrogen filled tyres	•	•
Picnic table	•	•
Electric awning with LED Strip	•	•
Side checkerplate protection	•	•
Slide out external kitchen with cook top and sink	✕	✕
Slide out Step	•	•
Under body protection flap	•	•
Under mounted gas bayonet for external cooking	•	•

# Jayco Toy Haulers



## Take the toys

17 ft Work 'N' Play Toy Hauler

23 ft Basestation Toy Hauler

Calling all adrenaline junkies – Jayco has the ultimate base for adventure-seeking outdoor pursuits with two models within this ‘not for the faint-hearted’ range; Jayco Work’n’Play and Jayco Basestation.

**Jayco Work’n’Play** - is part caravan, part garage, but all adventure.

At just 17ft in body length, Work’n’Play is a compact toy hauler that can be used as a mobile toolbox and can transform into a caravan/mobile garage for that quick getaway – making it a perfect option for that modern tradesman and activity based outdoor enthusiasts.

**Jayco Basestation** – this 23 ft Toy Hauler is designed for adrenaline junkies, motorbike riders or action-loving individuals who need optimal cargo area, holidays will never be better than in a Basestation.





The two unique floorplans have been designed with adventure in mind but comfort uncompromised with features such as innerspring mattress and seating made for relaxing.



Modern and spacious kitchens in both models and include a 2 or 3-burner cooktop, microwave oven, plenty of storage and a fridge.



The cleverly designed layout of the Basestation, has up to 4 bunks to offer plenty of sleeping options ideal for families or large groups.

## Ride in, ride out and get the adventures started!

At the core of Jayco's Toy Hauler range is clever design and use of space to create distinct living and adventure zones, no matter how big or small.

**Jayco Work 'n' Play** is compact with a narrow body width and lowered height to allow easy access to sites and it's lightweight that can be towed by popular medium-sized cars and SUVs. Featuring an external slide-out kitchen for that perfect outdoor cooking convenience and the Work'n'Play comfortably sleeps up to 6 people.

**Jayco Basestation** is a heavy hitter when it comes to big adventure. The living area provides all the comforts of home with a Dometic fridge, 3-burner cooktop, microwave, air conditioner, innerspring double bed mattress, and roll-out awning. Whilst the garage zone can easily store motorbikes, go-karts and surfboards, accessed by a fold down rear ramp. You'll never need to leave a dirt bike, kayak or quad bike at home again when adventuring in a Basestation.



New for 2020 is the inclusion of Ibis 4 air-conditioning, perfect for keeping cool at the end of your daily adventures.



Engineered for harsh Australian conditions. JTECH 2.0 suspension delivers greater stability, a smoother ride, more precise handling and increased ground clearance without increased ride height.

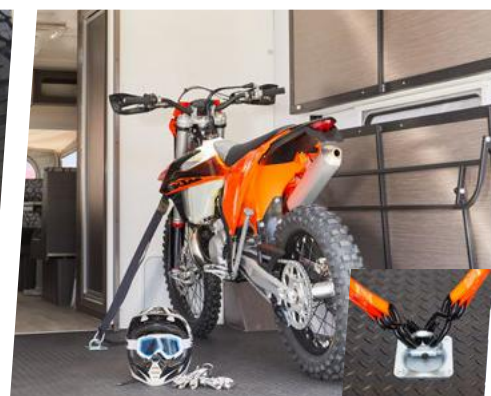

Built in hitch points allow bikes and other toys to be easily strapped in safe and sound. While the clever addition of dedicated storage lets you store your accessories on the go.



The large front boot lets you store more on your adventure. Never leave your tools, gear or accessories behind again!

# Toy Hauler Floorplans.

 Shower
  Refrigerator
  Wardrobe
  Pantry
  Sleeps standard
  Sleeps optional



## 17 ft Work ‘N’ Play

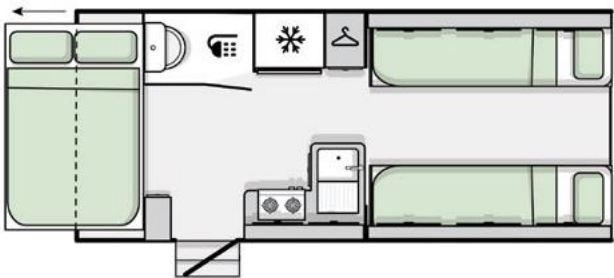

### 17.51-2 Tandem Axle

	WORK ‘N PLAY
Tare Weight (approx)	2100 kg
Towball Weight (approx)	228 kg
Body Length	5290 mm
Interior Height	1975 mm
Travel Height	3040 mm
Travel Length	6980 mm
Travel Width	2470 mm

## 23 ft Basestation

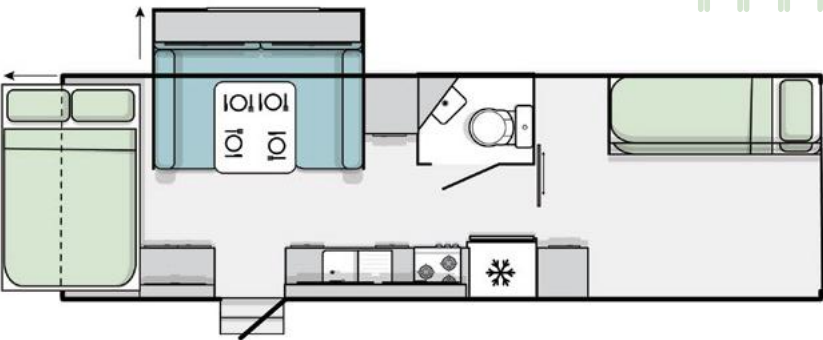

### 23.73-6 Tandem Axle

	BASESTATION
Tare Weight (approx)	2790 kg
Towball Weight (approx)	263 kg
Body Length	7370 mm
Interior Height	1975 mm
Travel Height	3040 mm
Travel Length	8715 mm
Travel Width	2470 mm

\* The weights and dimensional data are not binding. Jayco reserve the right to alter specifications without notice. These are a guide only and will change depending on accessories fitted to your van. It is advised to discuss this with your Jayco representative. The load carrying capacity of Jayco RV's vary from product to product to ensure it is fit-for-purpose.



# Toy Hauler Features.

• Standard    ✕ Optional    - Not Available    ^ Model Specific



	WORK 'N' PLAY	BASESTATION
<b>CONSTRUCTION</b>		
Chassis - Hot dipped galvanised	•	•
Furniture - Euro style with aluminium corners & seat framing	•	•
Roof - hail resistant one piece skin with insulation	•	•
Suspension - JTECH Suspension Independent Coil	•	•
Walls - fully insulated Toughframe, hail & dent resistant	•	•
<b>SAFETY</b>		
Brake Unit - Tow Secure Emergency Braking	•	•
External Triple Lock security door	•	•
Reversing Camera	✕	✕
Side Camera	✕	✕
Electric Brakes	•	•
Lockable Water Filler	•	•
Sway Command Tow Control	•	•
<b>STORAGE</b>		
EziGlide Drawers including Pot Drawer	•	•
Overhead storage compartment	•	•
Side Entry Boot	•	•
Slide out heavy duty storage drawer	✕	✕
<b>TECHNOLOGY</b>		
100 Ah Battery	•	•
Additional 100 Ah Battery	✕	✕
24" LED 12v TV with built in DVD player	✕	✕
Amazon Echo Dot smart speaker with Alexa Voice control	✕	✕
Bluetooth enabled for battery and water tank monitoring app	•	•
Built in battery management system with built in 240v charger	•	•
CD/Radio with Internal & External Speakers	✕	✕
Internal mounted WiFi system with built in GPS	✕	✕

	WORK 'N' PLAY	BASESTATION
<b>TECHNOLOGY (continued)</b>		
LED display for battery and water tank monitoring	✕	✕
Roof mounted 160w Solar Panel with regulator	✕	✕
Additional roof mounted 120w Solar Panel	✕	✕
Roof mounted TV antenna	✕	✕
Satellite System	✕	✕
Winegard Sensor Pro Signal Amplifier	✕	✕
<b>INTERIOR FEATURES</b>		
171L Fridge with separate freezer compartment	-	•
95L Fridge with freezer compartment	•	-
3 Burner Cook top	•	•
4 Burner Cooktop with built in Griller	✕	✕
4 Burner Cooktop with built in Griller & Oven	✕	✕
Gas Hot Water System	•	•
High density foam mattresses to bunk areas^	•	•
Innerspring Mattress to main bed	•	•
Microwave	✕	•
Modern design shower with exhaust fan	•	•
Purpose designed fitted sheets (Main bed only)	•	•
Rangehood with 12v LED light & twin fans	•	•
Roof mounted Air Conditioner	•	•
Roof mounted Air Conditioner to garage area	-	✕
Seating area with selection of modern fabrics	•	•
Seating area with selection of durable leatherette	✕	✕
Seating area with selection of genuine leather	✕	✕
Shurflo 12v Water pump	•	•
Washing Machine with 3kg capacity	-	✕
Water filtration system to sink	✕	✕

	WORK 'N' PLAY	BASESTATION
<b>EXTERIOR FEATURES</b>		
12v Power outlet doorside	•	•
12v Roll out Awning with LED light	•	•
240v Power outlet doorside	•	•
Alloys & Tyres - 235/75R15 AT including spare	•	•
Awning walls	✕	-
Corner steadies - Drop	•	•
Extended A-Frame	✕	✕
External entertainment hatch including swivel TV bracket	✕	✕
External shower hatch with pop up tent	✕	✕
Fresh Water tank - 2 x 80L	•	•
Gas Bottles - 2 x 9kg	•	•
Grey Water tank^	✕	✕
Jerry Can holder	•	•
Jockey Wheel - Side mount	•	•
Light - LED 12v doorside	•	•
Light - LED 12v grab handle	•	•
Mains pressure to A-Frame tap	•	•
Mudflaps	•	•
Nitrogen filled tyres	•	•
Picnic table	✕	✕
Roll out awning with LED Strip light	•	•
Side checkerplate protection	•	•
Slide out external kitchen with cook top and sink	✕	✕
Tent section - One Piece, Double Stitched, heavy duty canvas & Boltiflex	•	•
Under mounted gas bayonet for external cooking	•	•

# Construction you can rely on.



## TOUGH FRAME

Jayco's vacuum-bonded quad-layer wall construction technology is both stronger and lighter than the conventional 'timber & tin' aluminium-clad caravan walls. Built on lightweight aluminium frame for extra strength and longevity, Tough Frame provides great thermal and acoustic insulation. The furniture in your Jayco caravan is built on our patented aluminium frame for strength and durability.

- 1 Hail and dent resistant, aerodynamic fibreglass exterior with high gloss finish.
- 2 External 3mm plywood board to increase structural strength.
- 3 Aluminium frame - not timber - for extra strength, plus galvanised plating for secure fitment of internal furniture.
- 4 Internal high-density polystyrene foam for superior insulation.
- 5 Internal 3mm plywood board CE coated for maximum durability.



## JTECH 2.0 SUSPENSION

Jayco Caravans come with a precision manufactured suspension system (standard on Outback). The specially designed, high-performance JTECH Suspension delivers greater stability, a smoother ride, exceptional handling and increased ground clearance.

Purpose-built to complement the Jayco Endurance chassis, JTECH independent coil suspension delivers greater stability, precise handling and increased ground clearance for easy and safe towing.

Each JTECH Suspension system includes:

- Electro-coated surfaces for protection against corrosion and stone chips
- Stub axles, bearings and brakes that are suitable for fitment of Lippert Sway command technology
- Large diameter, heavy-duty Pedders off-road shock absorbers and coil springs designed specifically for Jayco RVs and Australian conditions
- Aeon rubber springs inside each coil spring, producing a progressive rate when the suspension is compressed
- Toe-in and toe-out adjustment for wheel alignment

## ENDURANCE CHASSIS

An RV is only as strong as the base on which it's built, so we build our Endurance Chassis to last like no other. Lightweight yet super strong, it's hot dip galvanised for extra protection against corrosion, and features PSC member floor support, which better resist bending and compression, while also safeguarding under floor wiring and plumbing.

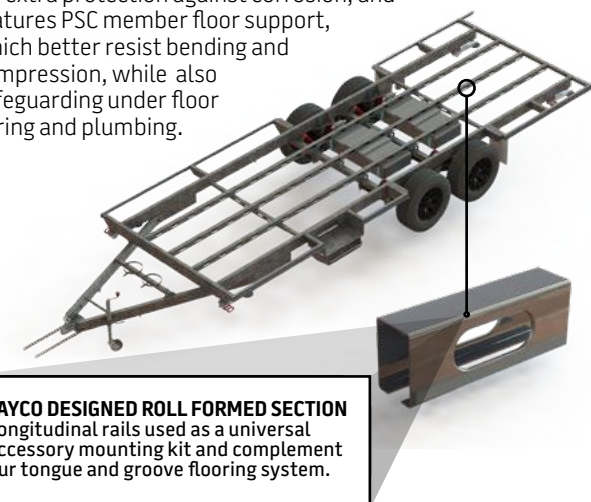

## ALUMINIUM FRAME

The furniture in your Jayco caravan is built on our patented aluminium frame for strength and durability.



# Durability & Design.



## OUTBACK UPGRADE

Even if the places you want to get to are a long way off the bitumen, there's no reason why you can't bring a little comfort with you. The Jayco Outback caravan has higher ground clearance, a range of high-strength componentry and specialised features, including:

- JTECH 2.0 Independent Suspension
- 100 AMP Battery
- 150 mm x 50 mm rectangular hollow-section chassis members
- 125 mm x 50 mm rectangular hollow-section A-Frame
- Jerry can holder on A-Frame (jerry can not included)<sup>^</sup>
- Off-road electric brake magnets
- Outback drop jacks
- Protective aluminium checker plate on sides
- 15-inch or 16-inch alloy wheels & tyres<sup>^</sup>
- Pull-out single step<sup>^</sup>
- External 12 V auxiliary plug
- External gas bayonet
- Jayco mud flaps
- 8-inch jockey wheel

**NOTE:** A Jayco Outback upgrade allows towing on limited unsealed roads. Always take care to prepare for unsealed road usage by understanding the road conditions and the associated towing requirements. We also recommend reading your Jayco Owner's Handbook for more information about warranty terms and conditions.

<sup>^</sup> Model specific

## UNRIVALLED COMFORT

Jayco continues to lead the way for Australian RV manufacturing and design and in 2020 the vision remains steadfast – maximise comfort through superior design, the Jayco way.

Uncompromised comfort is showcased throughout our 2020 ranges and is brought to life through innovative design and quality materials.

Jayco continues to innovate Australia's RV industry with an aspiration for Jayco RVs to stand the test of time. This includes style which incorporates design influences from Australia and Europe.

This is unrivalled comfort and superior design – the Jayco way.

# Safety you can trust.

## NITROGEN-FILLED TYRES

Nitrogen keeps your tyres as cool as possible and helps maintain a constant tyre pressure even in hotter weather, reducing the risk of blowouts.

## Sway command® tow control technology

Safety first, with Lippert Sway Command® Tow Control Technology



- A** Critical swerve or sway is detected.
- B** Sway Command® Tow Control partially applies the RV brakes. The caravan is pulled into line behind the tow vehicle. The sway is stopped and the caravan brakes are released.

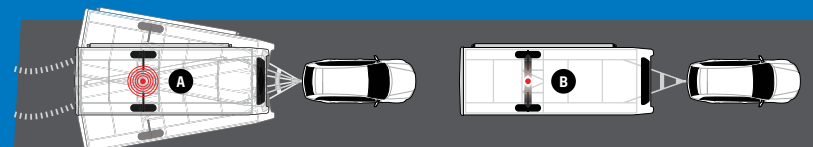

## BREAKAWAY SYSTEM

If a caravan accidentally separates from the tow vehicle, the system will activate the electric brakes and brake lights (optional).



# Optional features.

We believe your caravan should be uniquely your own. That's why Jayco offers the option upgrade to suit your needs- from choosing fabrics, bike racks and even a satellite dish so you'll never miss your favourite TV show again.



The best way to transport your two wheels is on a rear-wall bike rack.^



Solar panels will keep your batteries charged when no power is available.^



With a satellite dish, you'll never miss your favourite TV show or a Grand Final.^



The external picnic table is perfect for enjoying meals outside without bringing along a portable table.^



Ban hand washing with a compact washing machine in your RV.^



Furrion stereo package with internal and external speakers delivers high-quality sound.^



Enjoy your favourite shows and movies with a Furrion 12v TV/DVD.^



# The Jayco difference.



Jayco is Australia's leading RV manufacturer and for 45 years has pioneered the RV and caravan industry in Australia, resulting in Jayco being one of the country's most recognised brands known for its innovation advancements in creating quality and affordable recreational vehicles.

## AUSTRALIAN MADE

Designed and built by Australians, for Australians to take on the Australian terrain, all Jayco RVs proudly wear the Australian-made logo.

## BETTER VALUE

As the largest Australian RV manufacturer, Jayco has a great buying power and passes the savings on to our customers, delivering more features for less.

## GREAT RESALE VALUE

Jayco RVs keep their value exceptionally well and are considered to be a long-term investment.

## LARGEST SUPPORT NETWORK

No matter where your adventure takes you, Jayco's extensive service network will be nearby to assist in the unlikely event a priority repair is required. With **126 National Jayco Service Agent Representatives located around Australia**, the expertise or spare parts you need are never far away to help and is the most comprehensive RV service offering in Australia. Jayco's assist service is with you every step of the way. That's caravanning, the Jayco way.

## FINANCE THE DREAM

Financing your next adventure is easy and Jayco offers a number of finance options through Jayco Financial Services. This means we can provide a variety of loan options such as flexible loan terms from one to seven years, competitive finance deals, quick and easy approval, all supported by Jayco's exceptional customer service.

## INSURANCE

Jayco Platinum Insurance provides competitive premiums and market leading cover that is available at all Jayco dealerships or can be accessed online providing an easy to use and quick quoting portal. Whether you take your caravan on short holidays or year long travels, we can tailor a policy to suit your caravanning needs.





It's clear that Jayco is one of Australia's most impressive manufacturers and takes great pride in producing a range of the highest-quality products. We are just as proud to have the Jayco brand aligned with the Australian Made logo.

Ben Lazzaro, Chief Executive,  
Australian Made Campaign Ltd





Jayco Australia Factory (Dandenong South, Victoria)



#### Join our communities:

share your Jayco roadtrip with us  
on Facebook and Instagram

 @jaycoast  @jaycoaustralia #jaycoaustralia



Jayco Corporation Pty Ltd owns the copyright in this brochure. Unauthorised use, reproduction or adaptation is forbidden and will be prosecuted. Due to ongoing improvement, the specifications in this brochure are subject to change without notice.  
©JAYCO 2020 PO Box 636 Dandenong VIC Australia 3175.



JAYCO.COM.AU | 1300 JAYCO RV

